

## Helicomb / Worldwide Service for the Bell

# UH-1



# UH-1



Helicomb International, a division of PCC (Precision Castparts Corp.), specializes in the manufacture and repair of composite and metal bonded parts, sub-assemblies and assemblies for the Aerospace and Defense industries.

Helicomb is an approved FAA/EASA Repair Station, approved manufacturer for multiple OEM's and is source approved for multiple Department of Defense parts. We offer competitive pricing, quick turn-around time and a two (2) year warranty on all parts and services.

#### Certifications and Accreditations:

- AS9100/ISO9001
- Nadcap Composites
- Nadcap Chemical Processing
- ITAR Registered

#### FAA/EASA Approved Repair Station

- FAA Certified Repairmen
- FAA Diamond and Ruby Training Awards
- A&P Certified Mechanics

#### Qualified/Approved Manufacturer:

- Bell Helicopter
- Boeing Commercial and Defense
- Northrop Grumman Corp.
- Sikorsky Aircraft Corp.

#### Helicomb Offers:

- Quick Turn Time
- Finished Goods Inventory and Rotables for MRO
- Tool Fabrication
- Reverse Tooling for Legacy Aircraft Platforms
- Large Tooling Inventory for MRO and Spare Parts (on-site)

# UH-1

# Parts

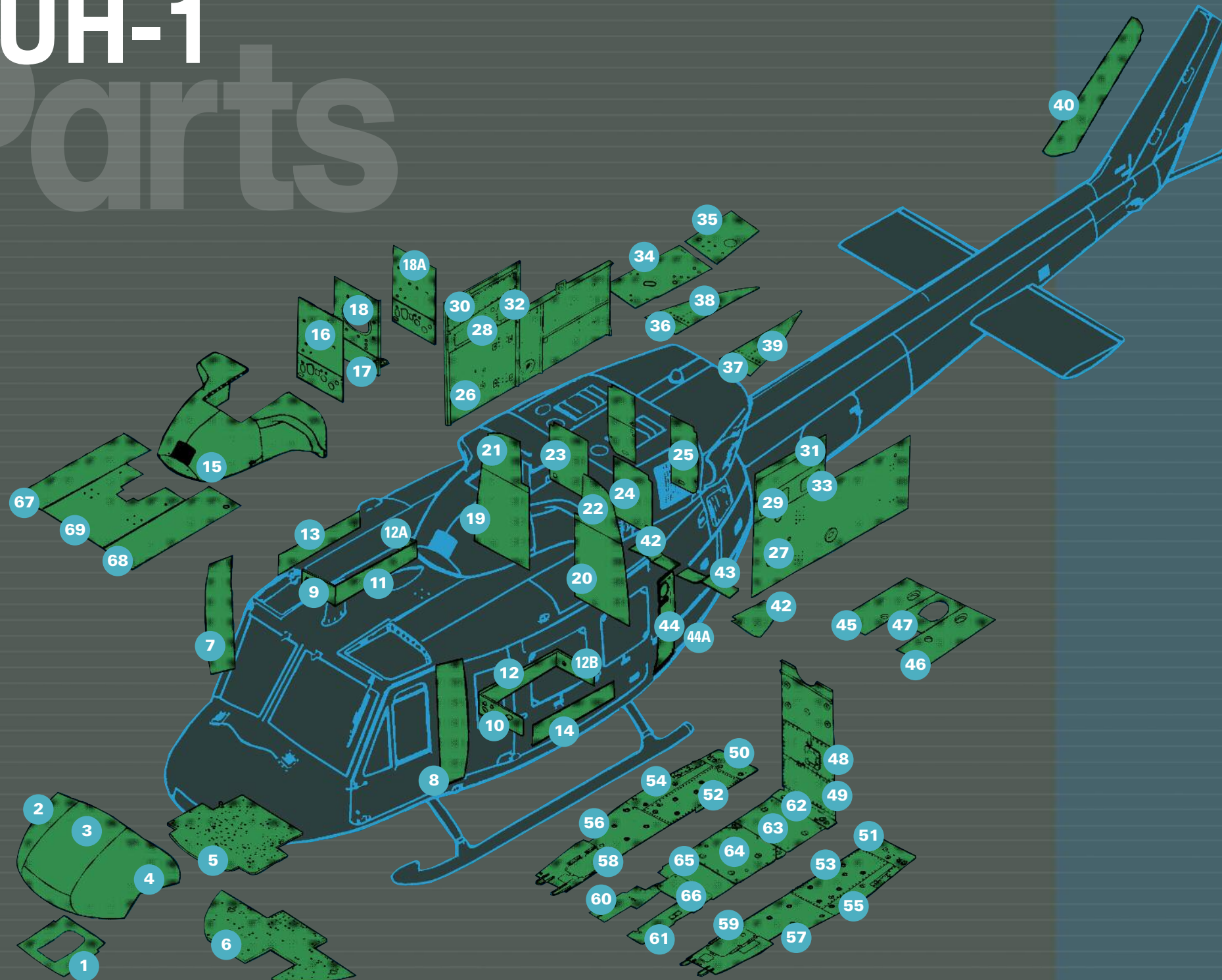

Description	UH-1H	UH-1N	
1	Lower Nose Panel	N/A	212-030-206-1
2	R/H Nose Skin	N/A	212-030-079-90 & 84
3	Nose Door	N/A	212-030-348-9
4	L/H Nose Skin	N/A	212-030-079-83 & 89
5	Upper Nose Shelf	N/A	212-030-065-11, 13, 93, 131, 143
6	Lower Nose Shelf	N/A	212-030-097-11, 67, 73
7	Door Post Panel R/H	205-030-277-49	205-031-277-81
8	Door Post Panel L/H	205-031-271-1	205-031-271-35
9	Bulkhead R/H	205-031-235-18	212-031-235-18
10	Bulkhead L/H	205-031-235-17	212-031-235-17
11	Inner Intercostal R/H	205-030-228-115	212-030-260-1 & 39
12	Inner Intercostal L/H	205-030-228-139	212-030-261-1
12A	Intercostal Panel R/H	205-030-179-52	205-031-179-55
12B	Intercostal Panel L/H	205-030-179-51	205-031-179-53
13	Outer Intercostal R/H	205-030-209-20	205-030-209-20
14	Outer Intercostal L/H	205-030-209-19	205-030-209-73
15	Fwd Fairing	205-060-805-21	212-060-801-1 & 3
16	Panel Fuselage, Cntr	205-030-200-31	205-030-200-83-& 95
17	Center Fuel Panel	205-030-396-89	212-030-253-3
18	Bulkhead Center	205-030-403-27 & 55	205-030-403-27 & 55
18A	Bulkhead	205-030-253-131 & 133	212-030-041-9, 13, 151, 153
19	Bulkhead R/H	205-030-407-286	205-030-407-446
20	Bulkhead L/H	205-030-407-21, 473, 285	205-030-407-445
21	Bulkhead R/H	205-030-407-25-329, 475	205-030-407-497
22	Bulkhead L/H	205-030-407-23 & 477	205-030-407-495
23	Bulkhead R/H	205-030-402-19 & 47	205-030-402-41 & 57
24	Bulkhead L/H	205-030-401-41 & 59	205-030-401-41 & 59
25	Bulkhead L/H	Contact us for this panel	212-153-001
26	Beam Assy R/H	205-030-169-389	212-030-179-93
27	Beam Assy L/H	205-030-169-387	212-030-169-7
28	Cover R/H	205-030-210-45	212-030-219-5
29	Cover L/H	205-031-210-47	212-030-144-1
30	Cover Main Beam R/H	205-031-221-2	212-030-014-1
31	Cover Main Beam L/H	205-031-221-1	212-030-262-1
32	Door Assy R/H	205-030-219-20	212-030-164-165
33	Door Assy L/H	205-030-219-19	212-030-163-93
34	Center Eng. Deck	205-031-197-127, 137, 155, 183	212-030-009-11
35	Aft Center Eng. Deck	N/A	212-030-101-1 & 3
36	Floor Assy R/H	205-030-173-4	205-030-173-66
37	Floor Assy L/H	205-030-173-3	205-030-173-65
38	Service Deck R/H	205-030-279-33	205-030-279-93
39	Service Deck L/H	205-030-280-29	205-030-280-103
40	Vertical Fin Cover	N/A	209-031-816-5
41	Shelf Assy	205-031-199-71 & 7	205-031-199-137 & 171
42	Fuel Tank Panel R/H	205-030-172-4 & -8	212-030-268-8
43	Fuel Tank Panel L/H	205-030-172-3 & -7	212-030-268-7
44	Panel Upper R/H	205-030-191-5	205-030-191-5
44A	Panel Upper L/H	205-030-191-7	205-030-191-7 & 41
45	Panel Assy Lwr R/H	205-031-282-70	205-031-282-58
46	Fuel Cell Panel L/H	205-031-282-69	205-031-282-57
47	Lower Belly Panel	205-030-772-87	205-030-772-97
48	Cover, Cntr. Fuselage	205-030-872-47	212-030-276-1
49	Cover, Cntr. Fuselage	205-030-953-25	205-030-953-25
50	Floor R/H	205-031-262-6	212-030-335-5
51	Floor L/H	205-031-262-5	212-030-335-1
52	Floor R/H	205-031-257-4	205-031-257-68
53	Floor L/H	205-031-257-3	205-031-257-67
54	Floor R/H	205-031-261-4	212-030-188-2
55	Floor L/H	205-031-261-3	212-030-188-1
56	Floor R/H	205-031-332-69	205-031-322-11
57	Floor L/H	205-031-332-67	205-031-332-9
58	Door Assy	205-031-327-1	212-030-250-1
59	Door Assy	205-031-327-1	212-030-250-1
60	Floor R/H Fwd	205-030-322-73	205-030-322-87
61	Floor L/H Fwd	205-030-322-61	205-030-322-83
62	Floor Aft Center	205-031-244-1	205-031-244-5
63	Floor Aft Center	205-031-326-3	205-031-326-5
64	Floor Aft Center	205-031-324-5	205-031-324-7
65	Panel Assy	205-031-258-5	205-031-258-5
66	Floor Panel	205-030-314-1	205-030-314-1 & 5
67	Roof Panel R/H	205-030-602-50	212-030-010-63
68	Roof Panel L/H	205-030-602-49 & 55	212-030-010-61
69	Center Roof	205-030-601-137	205-032-101-109